



The winter nights are drawing in and you might be pondering again about the heating in your church...



How long should you put the heating on before the congregation arrives on Sunday morning? Is it one hour, six or even twelve?

How do you answer the competing interests of people who say it's a very expensive luxury, or a waste of costly resources, or the ones who say a warm welcome is essential?

Available for you to borrow, we now have more simple-to-use thermometers that collect room data which you can download on your smartphone. You can see how long it takes for your spaces to warm up to the desired temperature and compare that with the external temperature, by day and by night. If you're putting the heating on too early, you can use the information to save money by reducing energy use and your carbon emissions too. You can also see how long it takes for your building to cool again and this might give you an opportunity to set the timer to switch off earlier.

We also have thermal imaging cameras to loan out. With these, you can see where cold drafts are coming in, where excessive heat is leaking out and whether your radiators are working effectively.

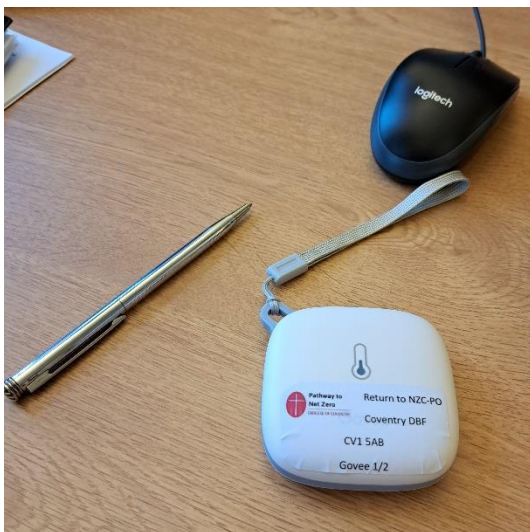

For more details, please contact [Colin Angus](#), Net Zero Carbon Project Officer.

